



FDA Owner Operator #10087657

SAFETY GUIDE

Use the See-Green® Plungers and Lens inserter for **INSERTION ONLY**. Do not use to remove lens. For removal, use the DMV Ultra Contact Lens remover.

REPLACE plungers and removers every three months for sanitary practice and better performance.

BEFORE USE: wash hands thoroughly with soap (without moisturizer) in warm/hot water, rinse & dry with lint free cloth before handling plunger and light.



AFTER USE: always wipe off the plunger, LED, black wire, white stand and battery box with isopropyl alcohol on a clean cloth or use a alcohol prep pad.



STORAGE: after use and cleaning, place your application and remover plunger in the See-Green® Vented Storage Vial between uses. **DO NOT** leave the plunger on the LED Light in between uses. Store LED light in a dry area.



WEEKLY - Wash plungers, plunger stands and Vented Storage Vial weekly with hot soapy water, rinse thoroughly and dry with a clean cloth. Do not wash the stand, plungers or vial in dishwasher.

CAUTION: Plunger & remover contain natural rubber latex which may cause allergic reactions. Per manufacturer, lab testing finds no antigenic proteins in this material. Silicone plungers are available on request

WARNINGS: Increased eye redness, pain, discharge, sensitivity to light, and/or significant reduction in vision may signal infection and requires IMMEDIATE attention. Please contact your primary eye care provider or eye doctor. Keep away from children – plungers are choking hazard.

Carefully follow all instructions from your eye care professionals about lens application, lens disinfection and storage.

Copyright © 2025 · Dalsey Adaptives, LLC · 1 Cottage St., Easthampton, MA 01027 U.S.A · (413) 563-2477
www.seegreenlight.com



FDA Owner Operator #10087657

USER GUIDE

See-Green® System, Light & Stand

Turn on light and attach plunger:

ALWAYS wet the bottom of the plunger with sterile saline containing no lubricant. While holding the bottom of the plunger, insert the LED bulb into the small hole with a twisting motion so only the clear part of the LED bulb enters the plunger. Don't bend wire.

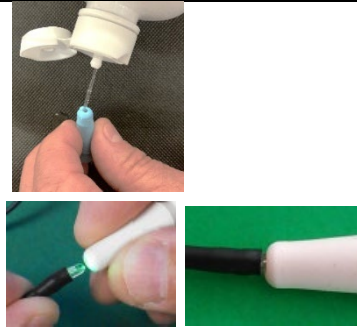

Place Plunger in the stand in the upright position. Allow the wire to feed into the slot.



Place the lens on the plunger lightly without generating suction. **Overfill** your lens with saline recommended by your doctor to improve your chances of a bubble-free application. Let the saline drip, not stream, into the lens.



The Lid Spread is Everything. **Hold open eyelids using both hands.** Look straight down. Lower your head smoothly and steadily while focusing on the green light in the hole in the plunger until you will feel the fluid. Press your eye downward onto the lens. **Capture the lens with the eyelids by releasing the lids.** Don't squint. Lift up your head, and the lens will come off the plunger if there isn't too much suction.

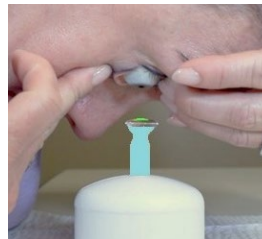

Courtesy BostonSight

Note: If the plunger remains on the lens when lifting up your head, squeeze the plunger to break suction now that your hand is free.

4) Check for bubbles. Using a mirror in a well-lit setting, check for the presence of bubbles. If bubbles are present, the lens must be removed with DMV remover and reapplied. See DMV remover instructions that came with your product.